

CAVA

## CAVA 1.14.1 – What's new

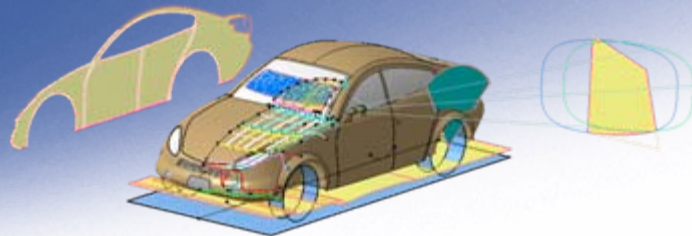

# TRANSCAT

A DASSAULT SYSTEMES COMPANY

# CAVA – „Tools/Options/..“ Settings



## Option to define default colors for

### Loading planes

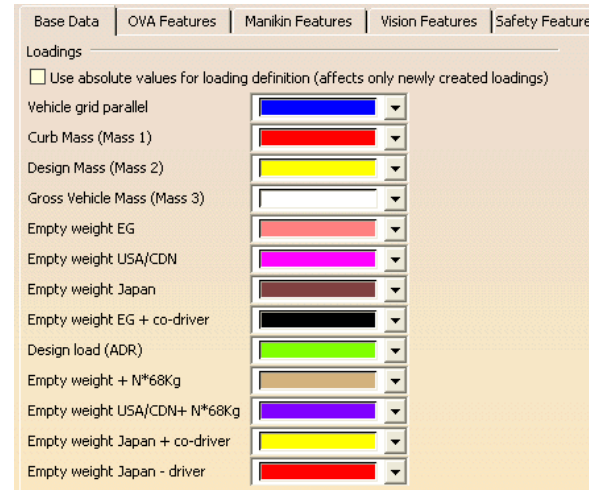

### Bumper pendulums

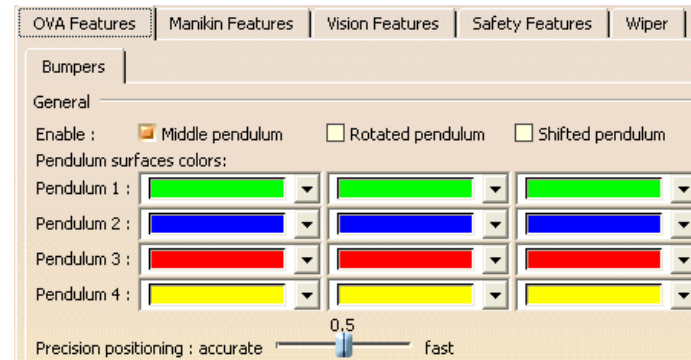

# CAVA – OVA



## Seat belts



Auxiliary lines help to understand creation of seat belt anchorage point field

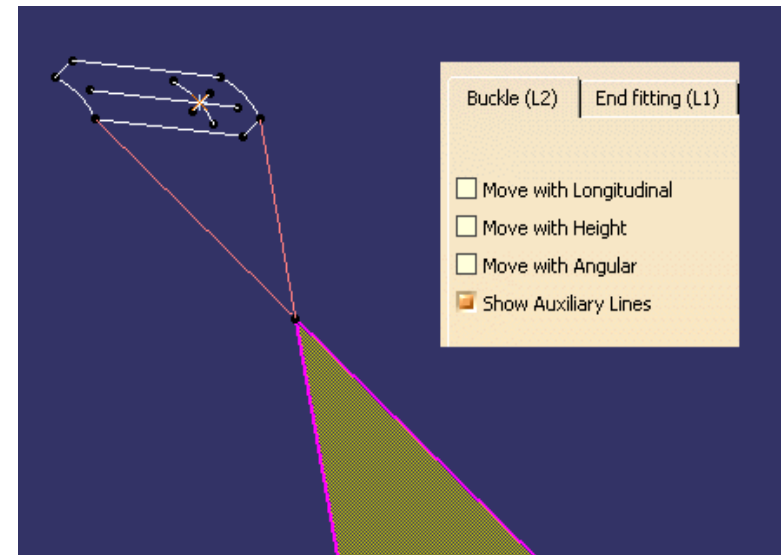

## Bumpers



- Improved visualization of US/Canadian pendulum profile
- Option to define specific color to each single pendulum

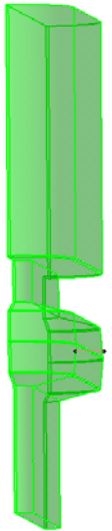
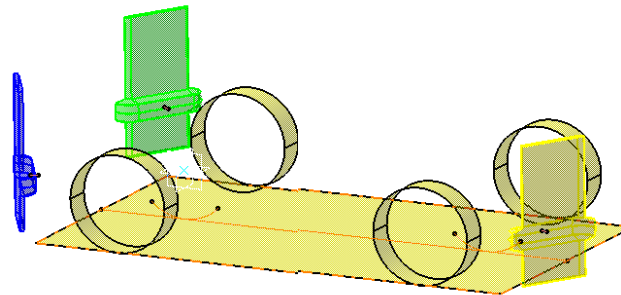

## Crash Barriers



- Added standard for IIHS with adopted barrier shape
  - IIHS 2009 centric
  - IIHS overlap (15%)

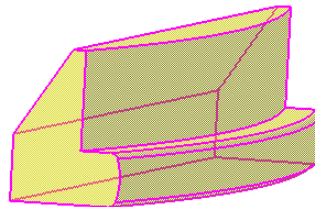

## Rear view Mirror

- 👤 New option to create mirror glass surface according to settings in GUI

- 👤 *Rotation point*
- 👤 *Glass contour*
- 👤 *Glass radius*
- 👤 *Horizontal and vertical rotation*

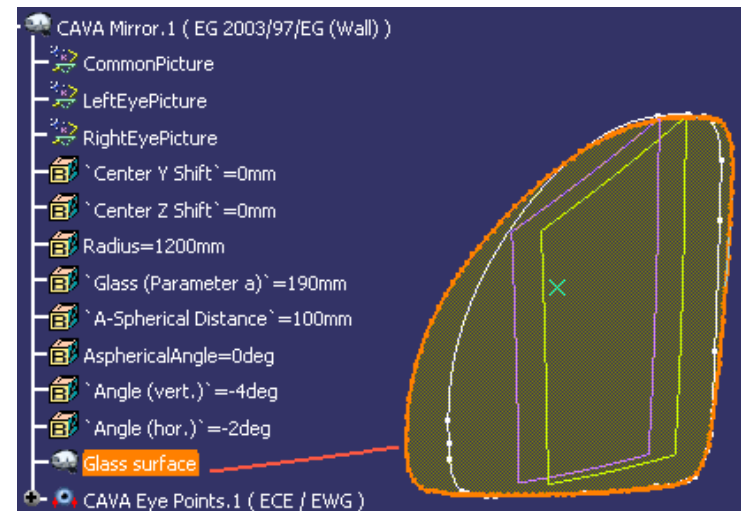
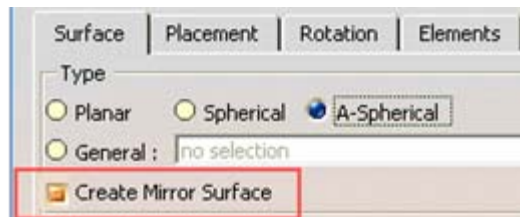

- 👤 Improved calculation time especially for general surface

# CAVA – Vision



## Optical Properties



- Improved handling of settings in GUI to use checks also for rear shield

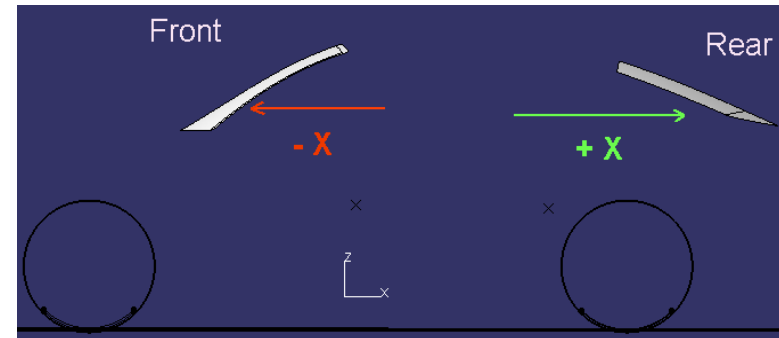
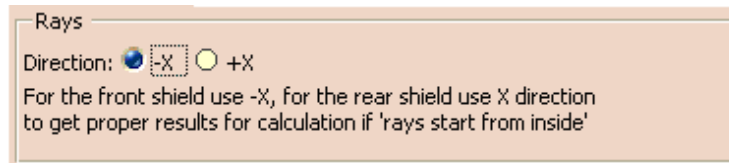

## Head Position Contour

- 👤 New option to visualize translated profile as surface
- 👤 Required values always editable to define car specific target values

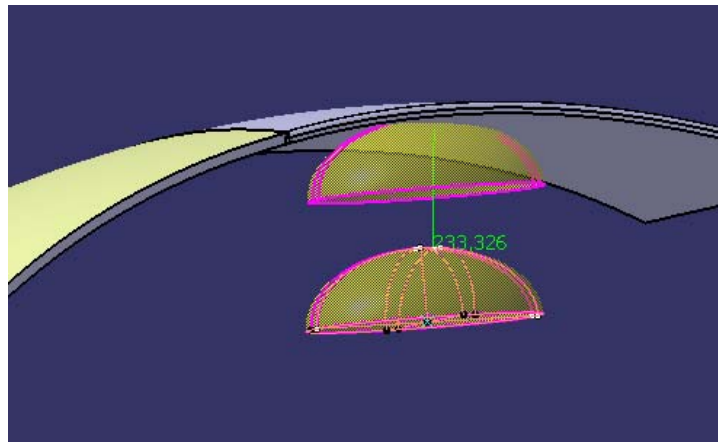

# CAVA - Safety



## Pedestrian Protection



### Wrap Around curves

New option to define unlimited number of WAD

Name	Value	State	Color	Offset	Color
Upper Bumper	20deg	<input checked="" type="checkbox"/>	Red	N/A	
Lower Bumper	25deg	<input type="checkbox"/>	Green	N/A	
Corner of Bumper	60deg	<input type="checkbox"/>	Blue	N/A	
Bonnet Leading	50deg	<input type="checkbox"/>	Orchid	<input type="checkbox"/>	Orchid
BonnetSide	45deg	<input type="checkbox"/>	Dark cyan	<input type="checkbox"/>	Dark cyan
WAD 1000	1000mm	<input type="checkbox"/>	Brown	N/A	
WAD 1700	1700mm	<input type="checkbox"/>	Yellow	N/A	
WAD 2100	2100mm	<input type="checkbox"/>	Cyan	N/A	
Bonnet Rear	N/A	<input type="checkbox"/>	Yellow	<input type="checkbox"/>	Yellow
Bonnet Top 1	N/A	<input type="checkbox"/>	Coral	N/A	
Bonnet Top 2	N/A	<input type="checkbox"/>	Blue violet	N/A	

Option to define user editable WAD curve

New option to define an alias name for the curves

- WAD 1000
- WAD 1700
- WAD 2100

## Safety Radius

 New ,separation surface‘

 Define, which part of the selected geometry (mainly intended for solids) should be used for the check.

Separation Surface (optional):   Invert

Element	Type	Inv...	Ra...	Fro...	Re...	Fl. ...	Treatment
Front Bumper	GE...	<input checked="" type="checkbox"/>	<input checked="" type="checkbox"/>	<input checked="" type="checkbox"/>	<input type="checkbox"/>	<input checked="" type="checkbox"/>	General

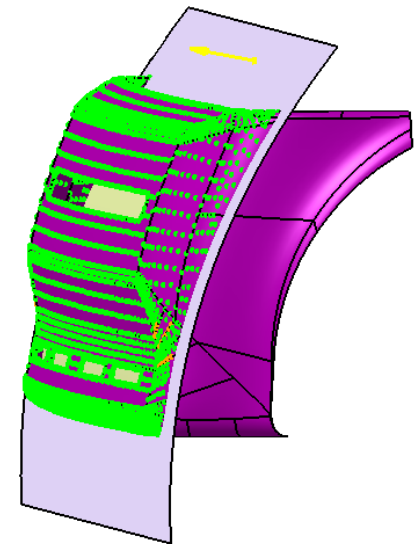

# CAVA – Wiper



- Additional Input parameter to define the starting position, in particular for the trapezoid wiper

The image displays two dialog boxes and a 3D diagram. The 'Driving Device Details' dialog box has 'Axis' set to 'Wiper Axis\_1', 'Axis X' as 'no selection', and 'Angle' as '0deg'. The 'Trapezoid Driving Device Details' dialog box has 'Top Axis (Extra)' as 'no selection', 'Top Axis' as 'no selection', 'Axis (Extra)' as 'Trapez Axis 2', and 'Axis' as 'Trapez Axis 1'. Under 'Trapezoid Device Extra Data', 'Calculate from top axes' is unchecked, 'Top' is 25mm, 'Outer' is 30mm, and 'Inner' is 60mm. The 3D diagram shows a wiper blade with coordinate systems  $X'''$ ,  $Z'''$ ,  $Y'''$ ,  $X''$ ,  $Z''$ ,  $Y''$ ,  $X'$ ,  $Z'$ ,  $Y'$ , and  $Z^o$ ,  $Y^o$ ,  $X^o$  at different points along the blade.

- New option to create the origin of used axis systems as V5 points

The image shows a CAD assembly tree on the left with 'Wiper.1' expanded to show 'Wiped Area', 'Wiper Demo Body', 'Blade Curve', 'Folding Origin', and 'Blade Origin'. The 'Folding Origin' and 'Blade Origin' are highlighted with red boxes. To the right is a 2D diagram showing a horizontal line with three coordinate systems (X, Y, Z) originating from different points along the line, marked with red asterisks.

# CAVA – Tools



## Silhouette



👤 New License 'CAVA-Tools' for Silhouette functionality

👤 *Now, icon is also available in Generative Shape Design workbench*

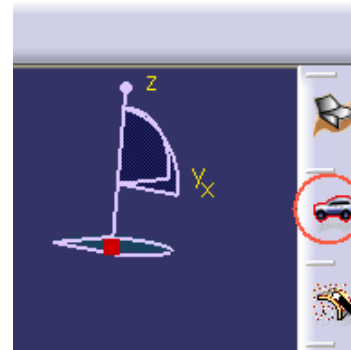
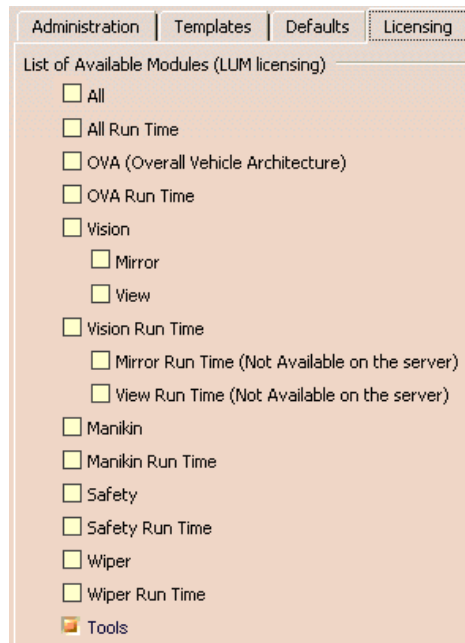

***TRANSCAT***

***THANK YOU***

[www.transcat-plm.com](http://www.transcat-plm.com)